

Superior vinyl and contour cutters

S CLASS 2™



The Summa S Class 2 cutter has a processor, which is seven times more powerful than its predecessor.

A vibrant color touchscreen, a network port, fast and reliable USB connection and an even faster OPOS sensor make the S Class 2 cutter prepared for many years to come.

Equipped with a new trim and sheet cut functionality, the cutter is now more than ever the perfect companion for large format printers.

Signmaking has evolved, which means, you need equipment that is both flexible and durable. Summa S Class 2 cutters are built on a foundation of rock-solid reliability and offer features to handle virtually any material you feed them with.



S2 75
Drag or Tangential Knife



S2 120
Drag or Tangential Knife



S2 140
Drag or Tangential Knife



S2 160
Drag or Tangential Knife

Advanced cutter for high-volume vinyl and digital print shops

From cutting vinyl to accurate, digital die-cutting to plotting on paper and beyond, the Summa S Class 2 cutter is a do-it-all cutter with the strength to do the job day in and day out.

Like the finely-tuned suspension in a sports car, our precision tracking lets us put more power under the hood to improve your performance. The S Class 2 cutter features a dual servomotor design that cuts amazingly fast, and Summa tracking lets you do it with complete confidence.

The accuracy of our European-crafted cutters is precisely what makes them so durable. Not only do you receive amazing reliability, you also get the confidence of knowing your expensive films and valuable vinyl prints will be cut precisely each and every time.

FEATURES & TECHNICAL SPECIFICATIONS

1. The Summa S Class 2 cutter is unquestionably the world's most advanced cutter. With its exclusive touch-control panel, it is also, by far, the easiest to use.
2. OPOS X contour cutting alignment delivers OPOS unparalleled accuracy and automation, even on laminated images.
3. The cutting head includes an automatic cut-off knife, which can optionally be set as to slice your media at the end of each job.
4. The Summa S Class 2 cutter is standardly equipped with an Ethernet port for fast and reliable connection to a network and a USB stick can be used to store jobs for later use.

Eight built-in and quickly accessible user configurations make switching between different jobs and media fast and easy



Powerful tangential head



Accurate OPOS X contour cutting



Vibrant color touch screen



Legendary tracking



Quick accessible user configurations



FlexCut feature

Model	S2 75	S2 120	S2 140	S2 160
Dimensions	141 x 68 x 111 cm	187 x 68 x 111 cm	202 x 68 x 111 cm	225 x 68 x 111 cm
Media Width	6 to 84 cm	12 to 130 cm	17 to 145 cm	17 to 168 cm
Cutting Area	74.2 cm x 50 m	120 cm x 50 m	135 cm x 50 m	158 cm x 50 m
	'Oversized' mode allows a wider cutting area : +/- 7 cm			
Repeatability (guaranteed)	Within +/- 0.1 mm on plots: up to 12 m long on rolls up to 760 mm wide <input type="checkbox"/> up to 4 m long on rolls over 760 mm wide <input type="checkbox"/>			
Accuracy	0.2 % of movement or 0.25 mm, whichever is greater			
Speed	Up to 141 cm/sec diagonal			
Acceleration	Up to 5.5 G diagonal			
Knife Pressure	Drag Knife: Up to 400 grams / Tangential Knife: Up to 600 grams			
Connectivity	USB; Ethernet			
Included Software	Cutter Control software; Winplot™ & MacSign™ Cut cutting software			

For complete specifications, please visit www.summa.eu



TANGENTIAL KNIFE TECHNOLOGY

Tangential cutting technology guarantees a superior performance compared to commonly used swivel knife techniques. The direction of the Tangential Knife is electronically controlled, enabling the T Series to cut very precisely and with very high pressures.

The perfect cut ensures weeding will be very easy, saving you valuable time. The patented nose piece prevents small pieces from being pushed out of the vinyl while cutting.

With up to 600 grams of cutting force, the Summa S Class 2 cutter powers through heavy sandblast, paint mask and reflective materials with incredible ease, speed and accuracy.

With a T model, you know you can do the job!

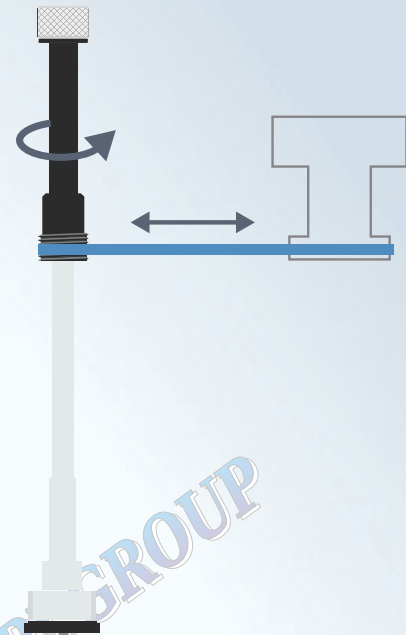
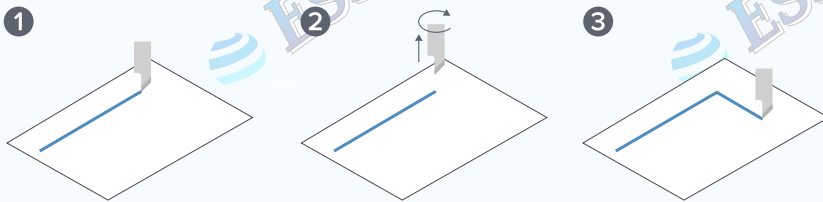

Tangential movement

- 1 The Tangential Knife stops cutting right before a corner.
- 2 A motor lifts and re-orientes the blade
- 3 Once the blade has reached the desired angle, it is lowered and continues to cut the corner.

DOUBLE TIP KNIFE

Summa tangential cutters can also drive Double Tip Knives, which have two cutting edges. This results in the dual tip being much more rigid, which will significantly elongate the knife's lifetime.

When penetrating the material, the dual tip automatically generates an overcut. Especially when cutting highly reflective materials, the extra overcut and rigidity prove their value in this hard, thick material.



OPOS CAMERA

With OPOS-CAM, Summa delivers yet another amazing innovation with the printing industry's first camera recognition alignment solution for friction-driven vinyl drum cutters.

Summa customers in volume-driven workflow environments will now be able to excel against the competition with extremely fast precision and accurate cutting of short or long run contour cutting jobs.

OPOS-CAM is a factory upgrade option now available on all new Summa S Class 2 S75T, S140T and S160T vinyl cutting plotters.



DRAG KNIFE TECHNOLOGY

Its simplicity has made Drag Knife (or swivel knife) technology the most commonly used. An offset parameter defines the distance between the knife tip and the rotating center.

In order to know the position of the freely rotating knife inside the knife holder, a drag movement is made, assuming the knife tip will follow accordingly.

Summa cutters include enhanced methods to optimize this drag movement in order to obtain the best possible cutting quality.

Drag movement

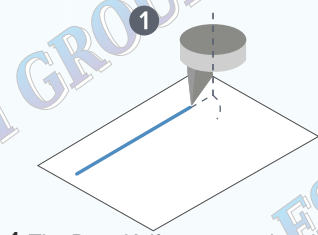

1 The Drag Knife stops cutting right before entering a corner.

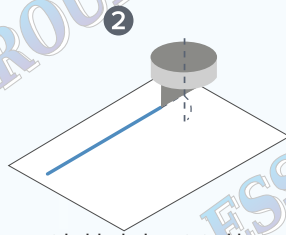

2 The eccentric blade is rotated by performing a drag movement to the desired angle, never leaving the media.

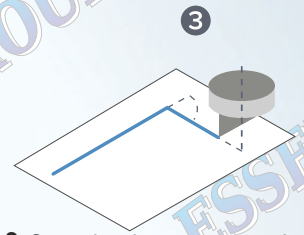

3 Once the drag-movement is completed, the corner cutting continues.

DUAL HEAD

As an option, the S Class 2 T Series and the SummaCut Series can be equipped with a cutting head with dual functionality.

This special Dual Head features an extra pen adaptor, instead of the OPOS sensor, allowing you to work alternately with each tool.

The perfect solution for drawing and cutting patterns in one easy step!



MEDIA OPTIONS

A servo-powered roll-up system ⁽¹⁾ (S2 160 & S2 140)

After a job is finished, the system will roll up the artwork neatly and prepare the machine for the next unattended job. The integrated paneling feature splits long-length runs into shorter consecutive jobs.

The S Class 2 can, therefore, cut complete rolls unattended and deliver the output nicely rolled-up.



A solid, most effective media rack ⁽²⁾ (S2 160 & S2 140)

Note: The roll-up system and the media rack cannot be combined.

Extra pinchrollers ⁽³⁾
(S Class 2 T Series & SummaCut Series)
Extra pinchrollers can be installed when required.